

# Jockey Pump Controller

## Type H300

Version 3.0



## Technical Datasheet

This controller is designed for the UK LPC / EN12845 market for controlling one electric motor driven jockey pump.

The ABS enclosure is rated at IP56, and is finished in grey to RAL 7035. The enclosure includes a left hand side door hinge, with ample room inside for wiring large incoming mains and motor cables. Four defined internal fixing points are included.

The standard design can be manufactured for three and single phase mains supplies. The three phase controller is rated as standard at 4.2kW, 415V maximum. Higher rating are available upon request.

The controller is designed to operate from a pressure switch two wire input, close to start. – open to stop. A minimum run timer can be added as an optional extra without changing the enclosure size. Dedicated cable terminals are provided for the pressure switch input.

Inside the controller is a three pole isolator (lockable in off only) with a fixed neutral connection and a high quality motor contactor. The overload is an auto resetting type, and is equipped with a phase failure feature to stop the motor in the event of a missing phase.

### Electrical Ratings, Standard unit:

Isolator:	3 pole, 600V, 16A. IEC/EN 60947-3. UL listed
Contactor:	9A, AC3. IEC/EN 60947-4-1. UL Listed. 240v coil.
Overload:	IEC/EN 60947-4-1. UL Listed
Terminals:	20A, 600v. IEC/EN 60947-7-1. UL recognised 6mm for neutral and earth, 2.5mm for pressure switch input.
Cable:	Tri-rated, 1.5mm throughout, with insulated crimps.
Overall:	415v motor at 4.2kW, 9A



Harrijess Ltd,  
Grantham, England.

Tel: +44(0) 1476 516677

**Dimensions:**

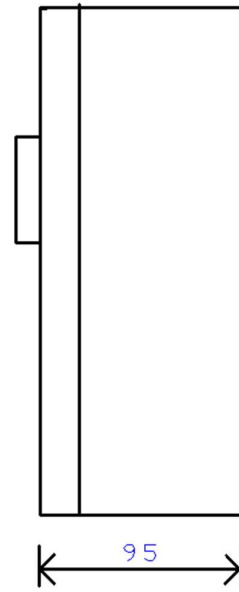
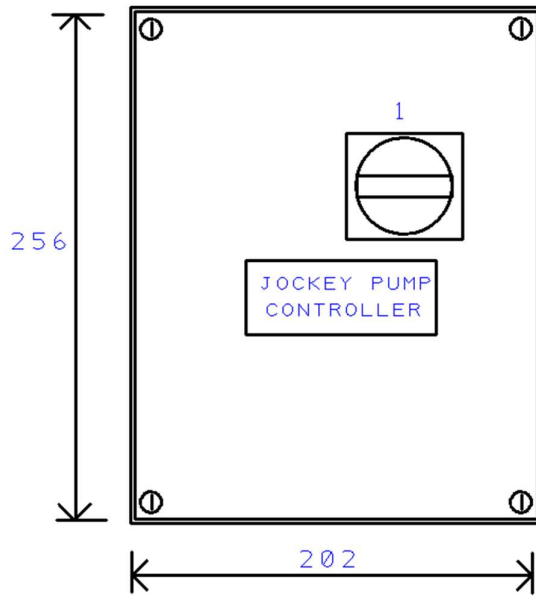

**Overload Ratings**

Amperage	Type
0.1 to 0.16A	3900
0.16 to 0.25A	3901
0.25 to 0.4A	3902
0.4 to 0.65A	3903
0.63 to 1A	3904
1 to 1.6A	3905
1.6 to 2.5A	3906
2.5 to 4A	3907
4 to 6.5A	3908
6.5 to 10A	3909

**Internal View:**

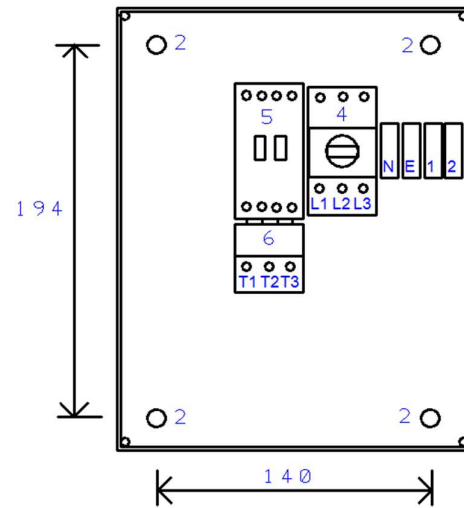

**Options:**

- H301: Motor running and power on lamp
- H302: Running and tripped volt free contacts
- H304: Minimum Run timer
- H308: No neutral (Additional transformer & larger box)
- Others upon request.

**Model number: H30z-xxkW-415v-option letter**

Note; Options can be combined, for example, minimum run timer (4) and lamps (1) would become a H305.